

WL380 PARTS DRAWING

Yellow = Consumables

Green = Recommended spare parts

Wetted Parts

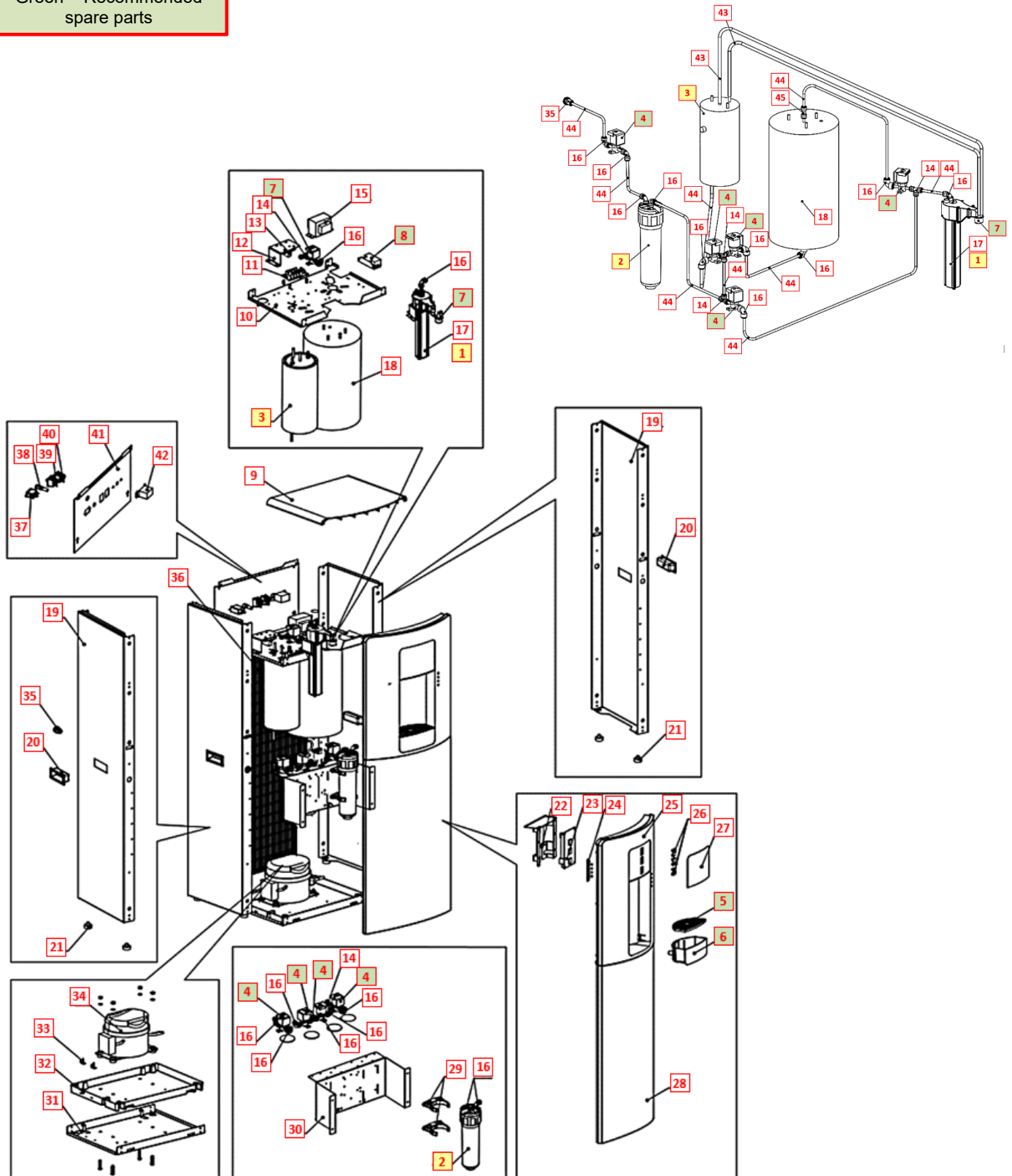

WL380 PARTS LIST

No	Part No	Description	WLCP Part No.	Stocked?	
Consumables					
1	10-8075	13W UV Lamp Assembly	CT-2090-C	Yes	
2	FT-0035-IL-WLT	GAC Filter - 10" Carbon Activated Inline Filter – Optional	FT-0035	Yes	
	FT-0063-IL-WLT	Carbon Block - 10" CBC 1 Micron Lead and Cyst Reduction Inline Filter – Optional	FT-0063	Yes	
	FT-0053-IL-WLT	Sediment Block - 10" Sediment 20 Micron Inline Filter – Optional	FT-0053	Yes	
3	10-4029	Hot Tank 120V/500W 1.6L with thermistor <u>*Thermistor not sold separately - sold with Hot Tank only</u> <i>Replace every 3-5 Years</i>	HT-3024	Yes	
3.1	12-1360	Overload with Manual reset - 221° F (105° C) <i>Recommend stocking 2 each per every 10 units purchased</i>	HT-3012	Yes	
Recommended Spare Parts					
4	12-1500	Solenoid Valve DC24V 1000mm <i>Recommend stocking 2 each per every 10 units purchased</i>	PU-4016	Yes	
4.1	CU-0001	Solenoid Cushion <i>Recommend stocking 2 each per every 10 units purchased</i>	CU-0001	Yes	
5	NA	Drip Tray Grill <i>Recommend stocking 4 each per every 10 units purchased</i>	PL-0029-L00-BL	No	
6	NA	Drip Tray Body <i>Recommend stocking 4 each per every 10 units purchased</i>	PL-0049-L00-BL-WLG	No	
7	NA	Hot Water Faucet <i>Recommend stocking 2 each per every 10 units purchased</i>	PL-1382	No	
8	12-8315	UV 15 W 120V/60Hz Electronic Ballast <i>Recommend stocking 2 each per every 10 units purchased</i>	EN-0008-L01-00	Yes	

Not Shown	01-2076	ScaleKleen <i>Recommend stocking 2 each per every 10 units purchased</i>	NA	Yes	
Remaining Parts					
9	NA	Black Top Cover	PL-1381	No	
10	NA	Upper Shelf	ST-0034-L00-00	No	
11	NA	Leak Detection PCB	EN-6111-A	No	
12	NA	3minutes UV Timer PCB Fixing Bracket	ST-8287	No	
13	NA	Relay PCB	EN-0010-L00-00	No	
14	Purchase from John Guest	JG Equal Tee Connector 1/4" (PI0208S)	PU-4011-A	No	
15	No	Power Transformer	EL-0016-L00-00	Yes	
16	Purchase from John Guest	JG Equal Elbow Connector 1/4" (PI0308S)	PU-4008	No	
17	NA	Firewall Assembly	FW-0015-L00-00	No	
17.1	NA	Firewall Bracket	FU-0002-B	No	
17.2	FW-0008-L00-00	Quartz Spiral – 22 Turns	FW-0008-L00-00	Yes	

17.3	NA	Firewall UV Fixing Rubber (Bung)	CT-2078-B	No	
17.4	AK-0064	UV Sensor with Wire	AK-0064	Yes	
17.5	NA	Spiral Rubber Buffer	FW-0020-L00-00	Yes	
18	NA	Cold Tank Assembly (4Liters, No UV holder, No sub-tank)- FW	CT-2017-A	No	
19	10-4002	Side Panel	ST-8225	Yes	
20	10-4004	Black Plastic Handle	PL-1120	Yes	
21	10-3083	Unit Rubber Feet	ST-8016	Yes	
22	NA	Display PCB Cover Bracket	ST-8340	No	
23	NA	Display PCB	EN-0024-L00-00	No	
24	NA	LED PCB	EN-6139	No	
25	NA	Black Top Front Panel	PL-0017-L00-BL	No	
26	NA	Top Front Button Cover	PL-1379	No	
27	NA	Hot - Cold - Ambient Label	LP-0309-L00-00	No	

28	NA	Front Bottom Panel	PL-0020-L00-BL	No	
29	20-1010	2.8" Filter Clip	PU-4161	Yes	
30	19-1016	Filter Bracket	ST-8206-CN	Yes	
30.1	14-5011	Drain valve and Cap 5/16"	CT-2028 and CT-2031-A	Yes	
30.2	NA	Drain Valve Clamp 1/4"	CT-2044	No	
31	12-1602	Bottom Shelf	ST-8035	Yes	
32	NA	Leak Tray	PL-0095-L00-00	No	
33	12-3180	Leak Containment Tray Clip (sensor 0.5mm)	ST-8207-CN	Yes	
34	10-2200	Compressor (R134a 1/8HP) 110V/60Hz	CO-9001-A	Yes	
34.1	10-3003	Compressor Starter Relay	CO-9016	Yes	
34.2	10-5018	Compressor Overload	CO-9015	Yes	
34.3	12-1001	Filter Dryer	CO-9008	Yes	
35	10-3067	Bulkhead Union 1/4" x 1/4" John Guest P/N PI1208S	PU-4028-A	Yes	

36	12-1000	Wire Condenser	CO-9007	Yes	
37	NA	Power Socket	EL-0061-L00-00	No	
37.1	19-1015	Gasket for Power Socket	ST-8052	Yes	
38	EL-5053	Fuse Holder and Fuse 120V / 15A with One Wire	EL-5053	Yes	
38.1	10-3013	Fuse 120V / 15A	EL-5010	Yes	
39	12-5600	Red Heater and Compressor Switch	EL-5019-A	Yes	
40	10-3009	Switch - Heater/Compressor	EL-5005	Yes	
41	12-1622	Black Back Panel	ST-8028	No	
42	19-1069	Cold Tank Thermostat	CT-2070-A	Yes	
43	10-7040	Silicon Tube 5/16" for hot water	PU-4064	Yes	
44	Purchase from John Guest	JG LLD PE Tube - Blue O.D.1/4" John Guest P/N PE-08-BI-1000F-B	PU-4031-A	No	
45	Purchase from John Guest	JG Equal Straight Connector 1/4"(PI0408S)	PU-4010	No	
Not Shown	AK-0014-B	Flow Restrictor 1.8mm Hole <u>Before inlet to Cold Tank</u>	AK-0014-B	Yes	
Not Shown	10-3007	Power Cord 120V – 1840 mm	EL-5001-B	Yes	