

SERVICE REQUIREMENTS

⚠ WARNING! *Read and understand the contents of this manual before attempting to service WL350 Water Treatment System. Failure to follow the instructions in this manual could result in death, serious personal injury, or severe property damage. Only trained and qualified technicians should attempt to install, maintain, or service Waterlogic Equipment.*

1. Visually inspect all electrical and water connections for signs of wear or damage.

⚠ DANGER! ***HIGH VOLTAGE ELECTRICAL HAZARD.** Unplug before inspection and service.*

2. **Waterlogic** recommends changing the UV Lamp every 6 months.

⚠ WARNING! ***ULTRAVIOLET RADIATION.** Protect your skin and eyes against ultraviolet rays. Never look directly at an operating UV light. Disconnect before removing UV Lamp.*

⚠ CAUTION! ***UV LAMPS ARE HAZARDOUS.** Lamps are considered Hazardous Waste and must be disposed of accordingly. Refer to Product MSDS sheet for details.*

3. Clean the Spiral Quartz Sleeve that surrounds the UV Lamp with a non-abrasive cloth, descaling solution, or ultrasonic bath if needed when changing UV Lamps.

⚠ CAUTION! ***UV SYSTEM IS FRAGILE.** Never handle the UV lamp or Quartz Sleeve with bare hands. UV Lamp and quartz sleeve must be free of oils and contaminants to ensure proper operation. Use a soft non-abrasive cloth to clean.*

4. Sanitize the Cold Tank per instructions in the pre-installation procedures.
5. Clean and sanitize external surfaces of the unit. Use soap and water or chemicals that are compatible with ABS plastic and will not damage or degrade the product surfaces.
6. Remove and clean the Faucet. Replace as needed.

⚠ WARNING! ***SANITIZER MAY CONTAIN HAZARDOUS CHEMICALS.** Use of proper personal protective equipment such as rubber gloves and eye protection is required.*

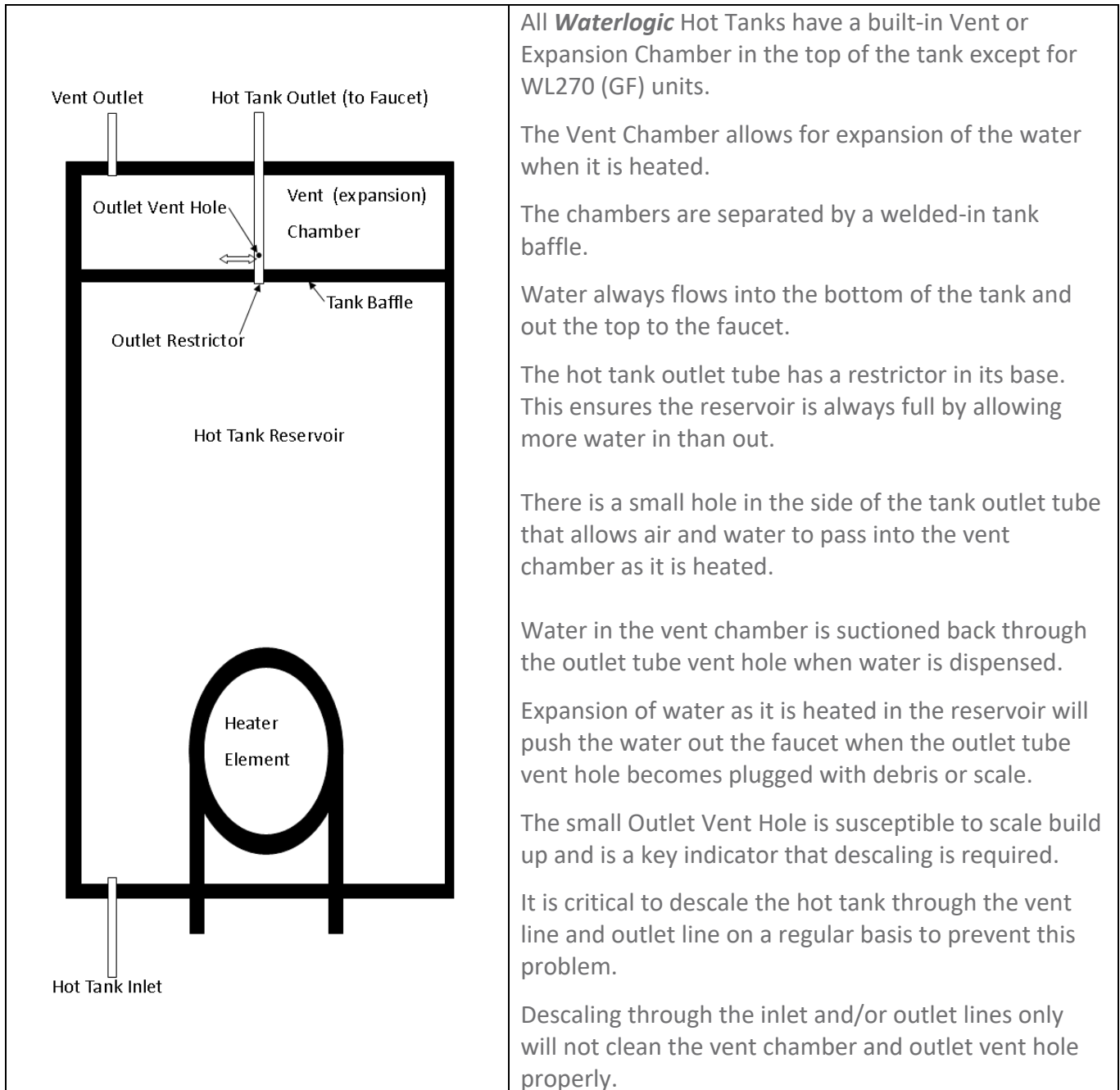

HOT TANK PRINCIPLES OF OPERATION



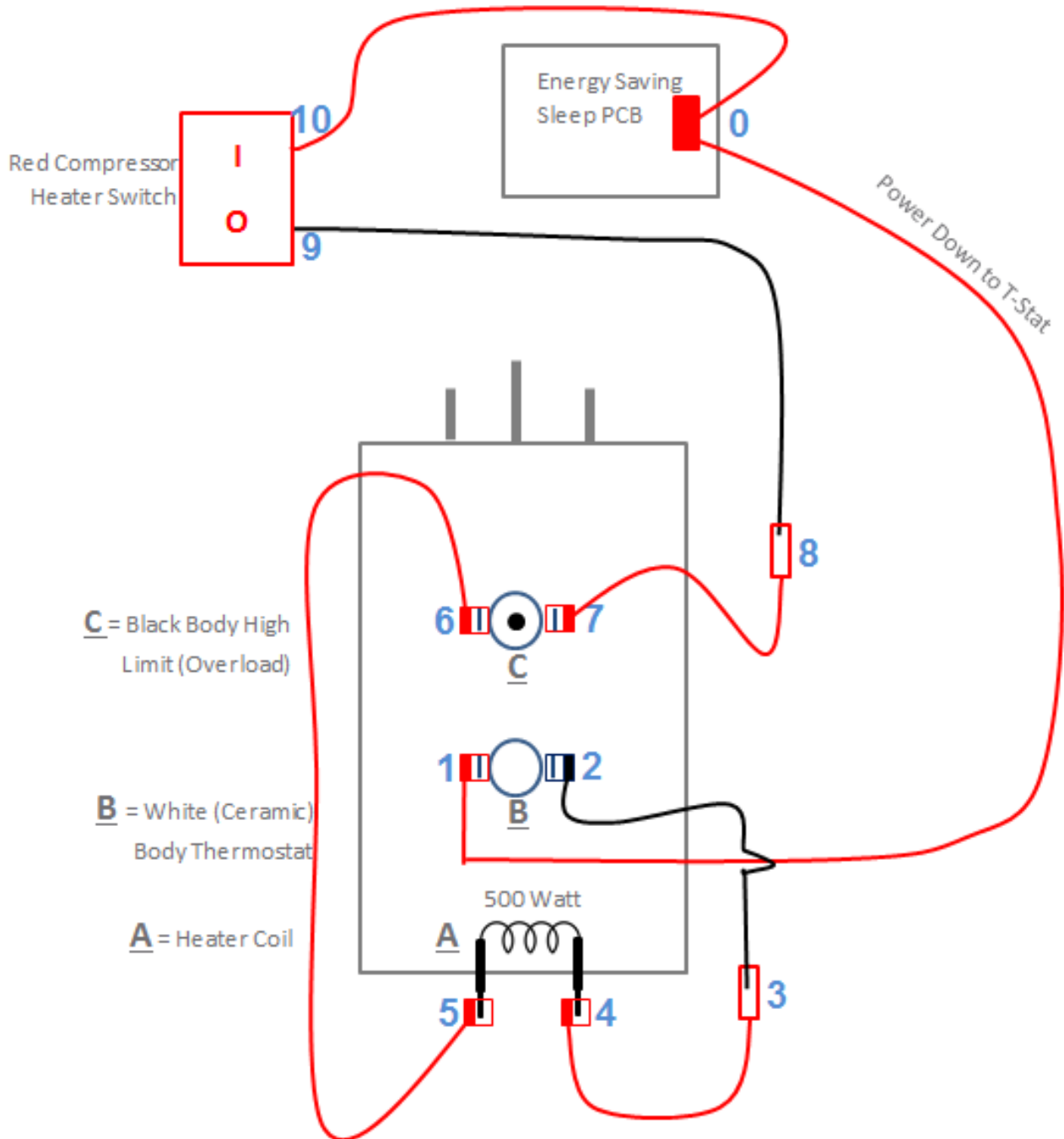



HEATER CIRCUIT – HOT TANK WIRING

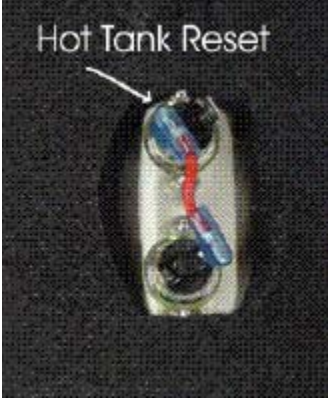

RESETTING THE HOT TANK OVERLOAD OR HIGH LIMIT SAFETY

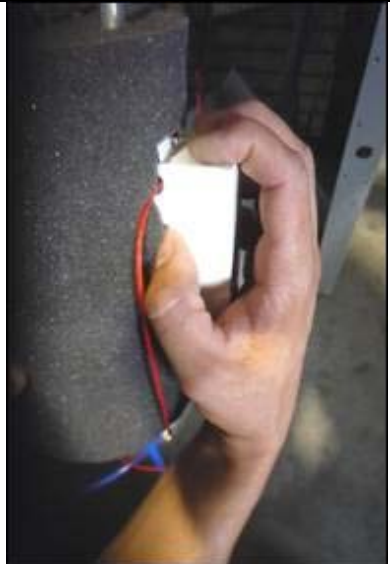
1.	Red Compressor/Heater Switch must be in the <i>O=OFF</i> position	
2.	Unplug the Power Cord from rear of WL350 Water Treatment System .	
3.	<p>Tower Model: Remove the <u>Lower Front Panel</u> by removing the Phillips Head Screws underneath the Lower Front Panel.</p> <p>Counter Top Model: Remove the <u>Side Panel</u> by removing Phillips Head Screws from Side Panel.</p>	
4.	Locate the Protective Metal Box on the rear of the hot tank. As you look through the condenser coils on the rear of the unit, you will see the hot tank located on the right-hand side.	
5.	<p>From the front of the Water Treatment System, reach up behind the hot tank and take hold of the protective metal box covering the thermostat and overload on the hot tank.</p> <p>There are nuts that secure the Protective Metal Box to the Hot Tank, are loose enough to allow you to remove the Protective Metal Box.</p> <p>If the nuts on the metal box are too tight, loosen the nuts securing the Hot Tank to the upper base of the WL350 Water Treatment System unit and lower the Hot Tank so you can remove the Protective Metal Box.</p>	

6.	<p>For demonstrative purposes, photos below have lowered the hot tank from the unit.</p> <p>Press the reset button</p> 	
7.	<p>Reattach the Protective Metal Box by depressing the top flap of the Protective Metal Box so it snaps back into its original position on the Hot Tank.</p>	
8.	Replace the Lower Front Panel.	
9.	Plug in the Power Cord.	
10.	<p>Turn on the Red Compressor/Heater Switch <i>I=ON</i> position</p> <p>The Hot and Cold tanks must be filled with water BEFORE turning on the Red Heater and Compressor Switch.</p>	
11.	Verify the cooler is fully operational before installing it at the customers' site.	

HOT TANK DESCALING INSTRUCTIONS

The Hot Tank requires removal of mineral deposits (descaling) on a regular basis. Typically descaling should take place every 6 to 12 months to preserve the long-term health of your unit.

Use non-toxic cleaner such as ScaleKleen, DEZCAL, 20% Citric Acid Solution, or Undiluted Vinegar Solution to remove mineral deposits as directed by the manufacturer depending upon filtration and local water conditions.

Descaling is an important process that removes calcium deposits, or scale, that can build up inside a tank over time. Calcium and scale is non-toxic but left unattended will hinder your unit's performance.

⚠️ WARNING! **PERSONAL PROTECTIVE EQUIPMENT REQUIRED.** *Always ensure proper ventilation and use rubber or nitrile gloves and eye protection when using chemicals. Refer to Material Safety Data Sheet for specific requirements of each product.*

⚠️ CAUTION! **STAINLESS STEEL TANK DESCALING.**
The Hot Tank is made from stainless steel. Ensure descaling solution is compatible with stainless and always flush the unit completely. Dispose in an environmentally safe manner.

Materials Needed:

- Personal Protective Equipment. Rubber or Nitrile Safety Gloves and Protective Eyewear
 - Phillips Screwdriver
 - Temperature Gauge
 - Water Pitcher or Container to collect water from the faucet
 - 19 Liter (5 gallon) container or drain basin
 - Citric Acid Based Cleaner
 - ¼" Plastic Tubing, at least 4 feet in length, and assorted ¼" quick connect fittings
 - Sanitizing Cartridge
 - Food Coloring
1. Put descaler per directions and 3 drops of food coloring into the descaling cartridge.
 2. Connect descaling cartridge to the inlet water supply and connect to Inlet Bulkhead Fitting on the back of the **WL350 Water Treatment System**. Turn on Water Supply.
 3. Select Hot Water and depress the Main Dispensing Button on the Front Control Panel until descaling solution (colored water) comes out of the faucet. Container and drain basic will be required to catch water from the faucet.
 4. Turn off water supply and remove sanitizing cartridge from inlet water supply. Reconnect water supply to inlet fitting.

5. Allow descaling solution to remain in the Hot Tank for 15 minutes (length of time may vary depending on water conditions).
6. Place a pitcher, catch basin or other container under the faucet of the **WL350 Water Treatment System**.
7. Flush the Hot Tank until water runs clear.
8. Once clear Water dispenses from the faucet the Hot Tank has been descaled. Always ensure the **WL350 Water Treatment System** is performing to the customer's satisfaction.

⚠ WARNING! HOT WATER. *The WL350 Water Treatment System produces Hot Water up to 86°C (187°F). Water above 52°C (125°F) can cause severe burns or scalding. Hot water should be dispensed carefully into insulated container to avoid injury.*

⚠ CAUTION! MUST REPLACE HOT TANK 3-5 YEARS DEPENDING ON USAGE. *The Hot Tank and its controls must be replaced a minimum of every three to five years to ensure efficient and dependable operation.*

⚠ WARNING! REINSTALL ALL PANELS AND COVERS. *Always reinstall all Panels, Protective Covers, and Fasteners after servicing equipment. Failure to do so could result in severe personal injury and will void the certifications and warranty of the equipment.*

FIREWALL OUTLET SOLENOID – REVERSE FLOW ORIENTATION

Firewall Outlet Solenoid – Reverse Flow Orientation

Firewall outlet solenoid must be installed backwards or reverse flow to allow water expansion bypass and prevent over pressure and bursting of the cold tank.

Solenoid Flow Indicator shown should point toward cold tank as shown below:

Flow
Indicator
Arrow

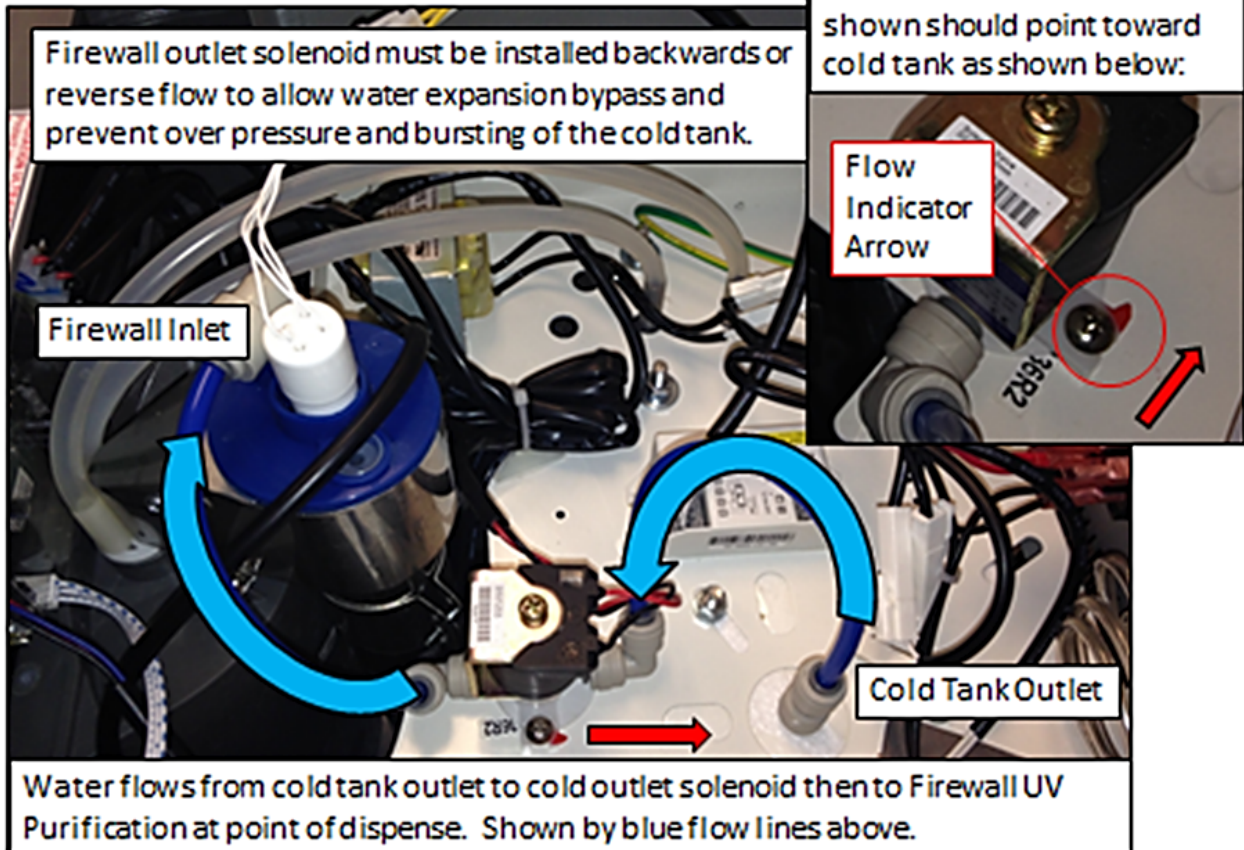

LG COMPRESSOR UPGRADE

*Parts List in this manual updated to reflect these changes.

New LG Compressor 120V R134A 1/8HP CSB035LJCM with external start/run capacitor.

New LG Compressor with External Start/Run Capacitor



External Capacitor

New LG CSB035 LJCM Compressor

Repair/Replacement Parts for are not interchangeable with older/other compressors.

Older version of LG compressor is obsolete and no longer available.

New LG CSB035LJCM 120V R134A 1/8HP Compressor Repair Parts

Part # CO-0017-L00-00	LG Compressor 120V CSB035LJCM-PTC Relay
Part # CO-0018-L00-00	LG Compressor 120V CSB035LJCM-Overload Protector
Part # CO-0019-L00-00	LG Compressor 120V CSB035LJCM-Capacitor

ADJUSTING COLD SET POINT

Cold Water Temperature – Factory Set Point is 41°F (5°C) and can be adjusted to 34°F - 54°F (1.1°C to 12.2°C)

The cold set point can be adjusted by accessing the cold thermostat adjustment screw under the decal at the rear of the unit.



Remove the red portion of the Cold Tank Temperature label to access the adjustment screw.

The factory set point is ~41°F and is indicated by the dot on sheet metal.



Turning the adjustment screw clockwise to lower the set point temperature.

Do not adjust past the “Max Cold” position at 3:00 position to avoid freezing the cold tank.



Turning the adjustment screw counter-clockwise to raise the set point temperature.

PROGRAMMING INSTRUCTIONS

DISABLING ENERGY SAVING SLEEP MODE

All **WL350 Water Treatment Systems** come from the factory with Energy Saving Sleep Mode engaged to meet the Energy Star Certification requirements. Energy Saving Sleep Mode disables the heater circuit if the unit has not been used for a continuous 3 hour or longer period. Selecting any button "wakes up" the **WL350 Water Treatment System** and turns the heater circuit back on. The hot tank will typically take less than 10 minutes to heat the water from ambient to the 85°C (185°F) set point.

Unplug Power Cord and remove Top Cover to access Heater Control PCB.

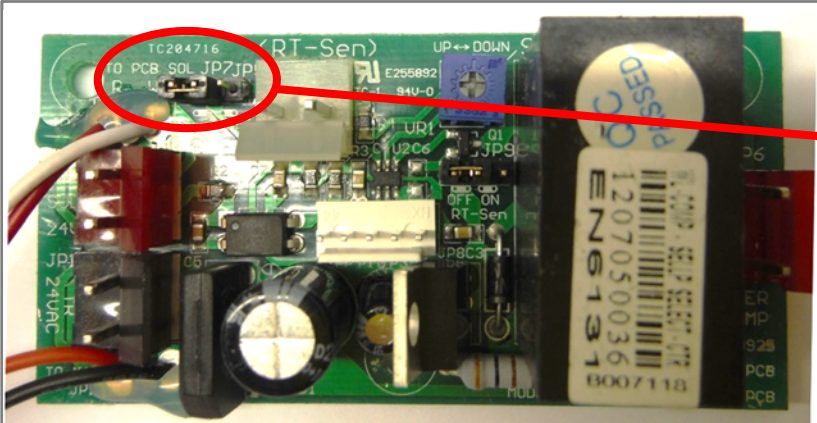
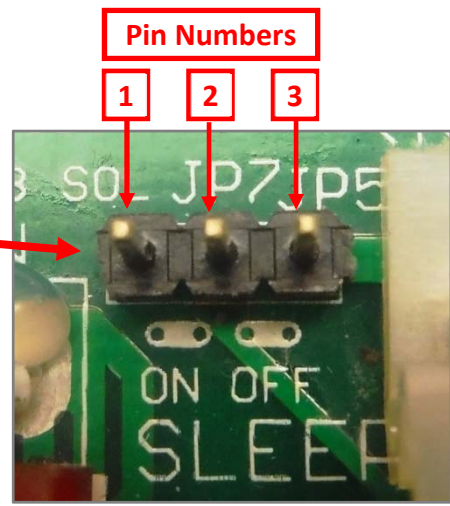
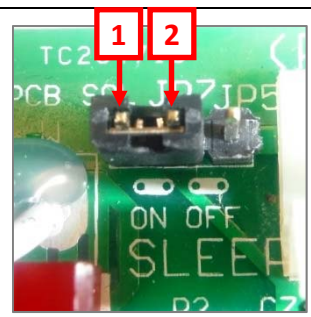
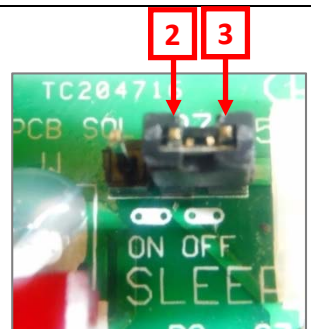
Heater Control PCB- P/N EN-6131 – WLCP PN 20-0075	
	
<p>WL350 Water Treatment Systems comes with the Energy Saving Sleep Mode "ON" - the Default Position.</p> <p>PCB Jumper JP7 in the "ON" position (Pin 1 and 2)</p>	
<p>Deactivate the Energy Saving Sleep Mode by moving PCB Jumper JP7 to the "OFF" position (Pins 2 and 3).</p>	

PROGRAMMING INSTRUCTIONS

CHANGING FROM HOT TANK THERMOSTAT TO THERMISTOR CONTROL

All **WL350 Water Treatment Systems** come from the factory programmed for a Hot Tank Thermostat. Currently the WL350 Hot Tank uses a Thermostat. The option to change to a Thermistor Control is for a future Hot Tank design. *Do not change to Thermistor or it will disable the Hot Tank.*

Unplug Power Cord and remove Top Cover to access Heater Control PCB.

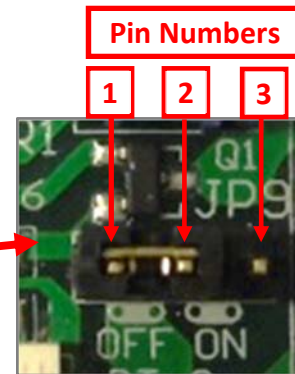
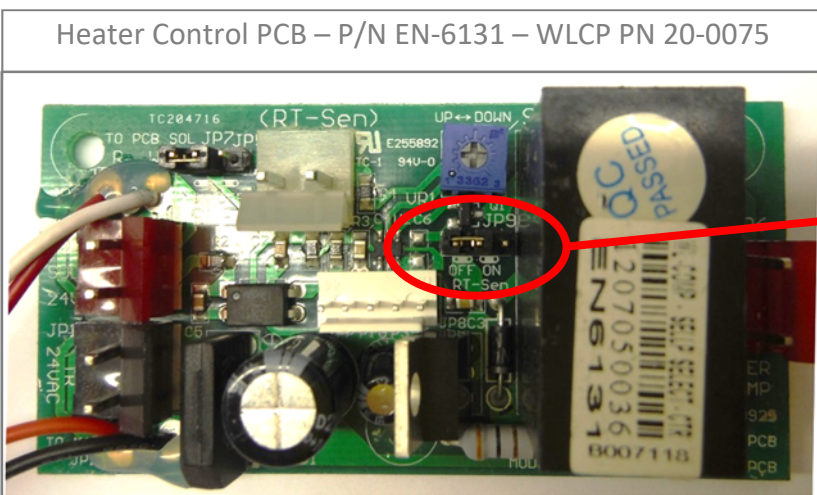

Thermostat Heater Control is the default.

PCB Jumper JP9 in the "ON" position (Pin 1 and 2)

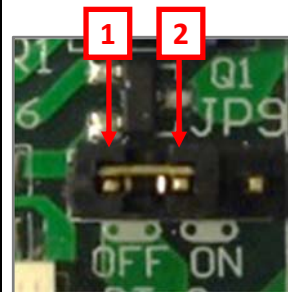

Thermistor Heater Control

The option to change to a Thermistor Control is for a future Hot Tank design.

Do not change to Thermistor, it will disable the Hot Tank.

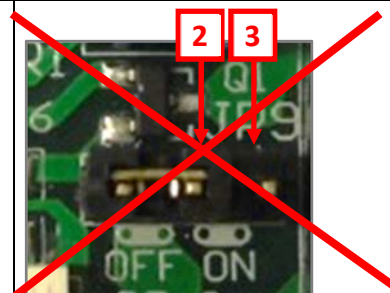

PROGRAMMING INSTRUCTIONS

DIP SET-UP CHANGING HOT WATER MODE TO AMBIENT WATER

WL350 Water Treatment Systems comes defaulted with Hot / Cold water, which can be changed to Ambient / Cold settings. DF1 settings default is to Hot /Cold.

Unplug Power Cord and remove Top Cover to access Energy Saver PCB.

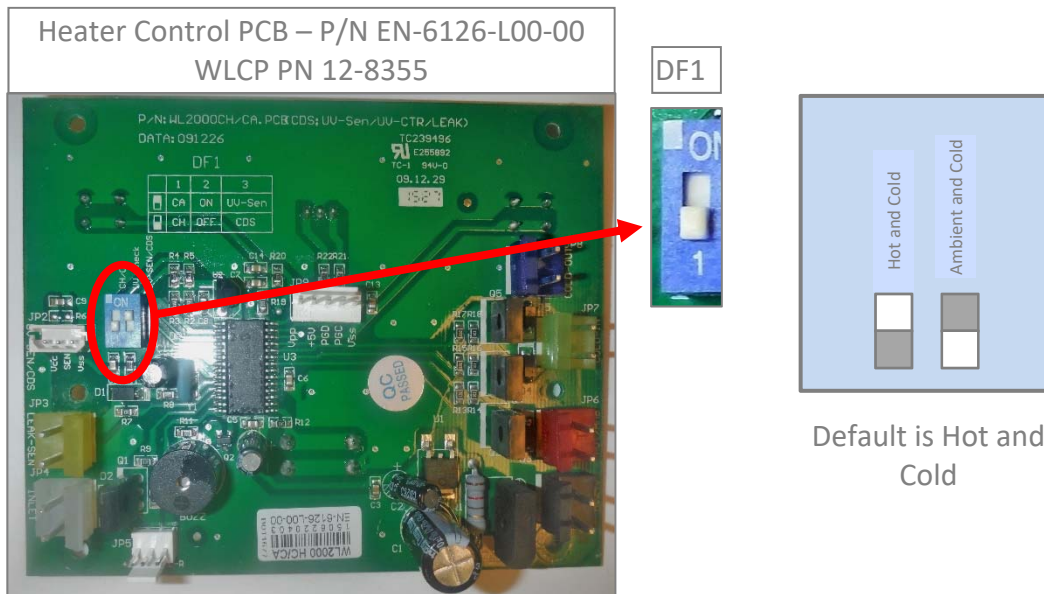

REPLACEMENT COMPONENTS - CONSUMABLES

Component	WLCP PN	Frequency of Replacement
15W LTFW XTM UV Lamp	12-8310	Every 6 months, or as required Factory Part No CT-2085-IA0-00
Hot Tank 87°C (187°F)	12-5615	Replace every 3 to 5 years depending on usage. Factory Part No HT-3041
1-micron 10" Inline CBC Filter for CTO, Lead, Cyst and Asbestos Reduction (Carbon Block) Required for NSF Certification	FT-0063-IL containing FT-0064 Filter Element	Every 6-months or every 1,250 gallons. Factory Part No FT-0063-IL Assembly containing FT-0064 Filter Element

** One pre-installed. One required for NSF-42 / NSF-53 Certification.*

Replacement parts can be obtained from *Waterlogic* or an *Authorized Waterlogic Dealer*. See Parts Layouts, Drawings, and Parts Lists for additional repair parts.

Hot Tank Service

Hot Tanks (with controls) must be replaced at least every 3 to 5 years depending on usage. Descaling Hot Tank may be required on a regular basis depending upon filtration and local water conditions. See Service Section.

NOTE:

At the **end of this product's life**, ensure that it is disposed of in an environmentally friendly manner which is fully compliant **with all Federal/State/Local Requirements and Guidelines**.

WL350 COUNTER TOP DRAWING AND PARTS LIST

Wetted Parts

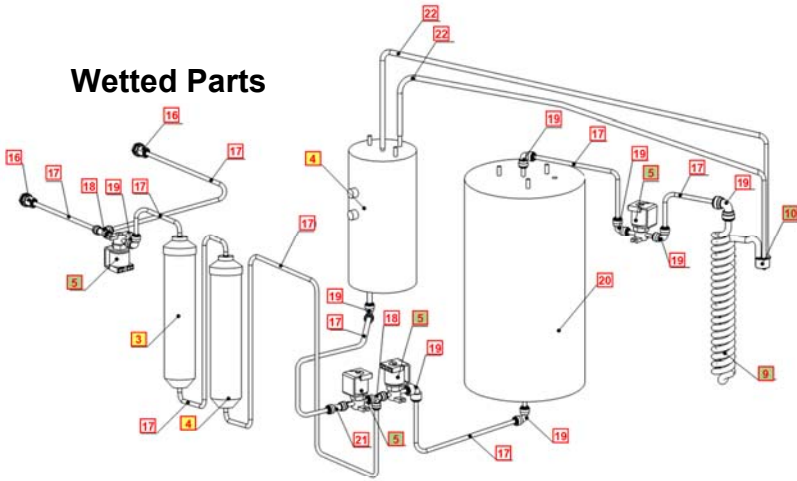

Yellow = Consumables

Green = Recommended spare parts

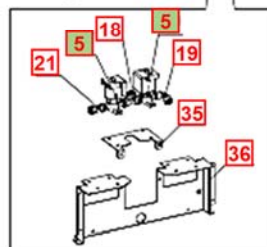
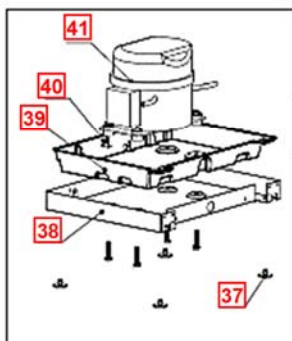
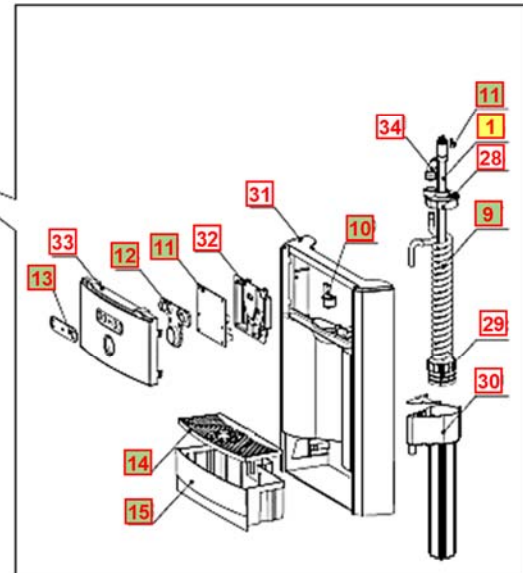
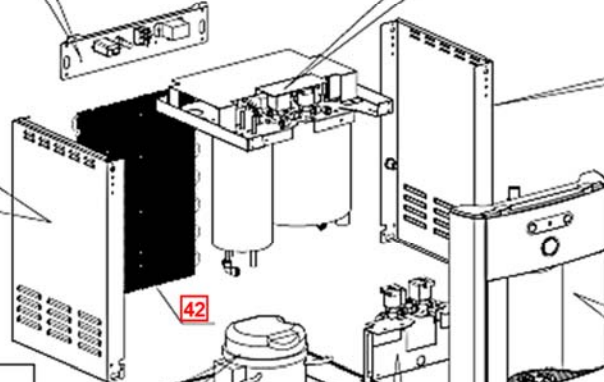
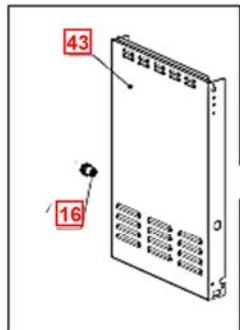
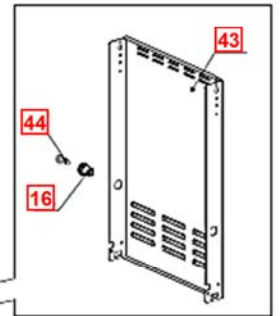
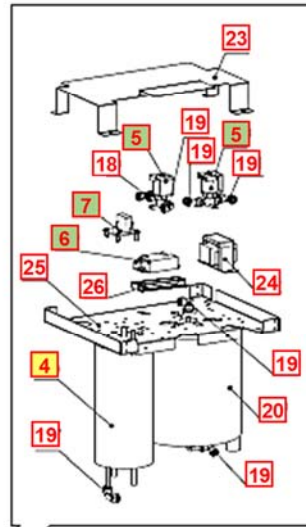
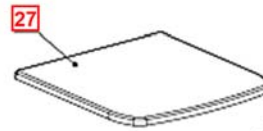
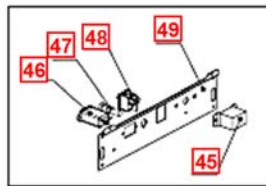

No	WLCP Part No	Description	Factory PN	Stocked?	
Consumables					
1	12-8310	15W LTFW XTM UV Lamp	CT-2085-IA0-00	Yes	
2	FT-0063-IL Assy with FT-0064 Element	1-micron 10" Inline CBC Filter for CTO, Lead, Cyst and Asbestos Reduction (Carbon Block) Required for NSF Certification	FT-0063-IL Assy with FT-0064 Element	Yes	
3	TBD	Waterlogic Filter Optional	TBD	Yes	
4	12-5615	Hot Tank 1.6 Liter (.42 gallon) 100V / 500W Factory Set Point 185°F - 85°C <i>Recommend stocking 2 each for every 10 units purchased</i>	HT-3041	Yes	
Recommended Spare Parts					
4.1	12-6900	Thermostat and Overload Metal Cover <i>Recommend stocking 2 each for every 10 units purchased</i>	ST-8290	Yes	
4.2	12-1360	Overload with Manual reset - 105°C (221° F) <i>Recommend stocking 2 each for every 10 units purchased</i>	HT-3012	Yes	
4.3	12-1303	Hot Tank Thermostat - (87°C) 187° F <i>Recommend stocking 2 each for every 10 units purchased</i>	HT-3013A	Yes	
5	TBD	Solenoid Valve 1000mm (recommend replacing Solenoid Cushion at same time) <i>Recommend stocking 2 each for every 10 units purchased</i>	PU-0017-100-00	Yes	
5.1	CU-0001	Solenoid Cushion <i>Recommend stocking 2 each for every 10 units purchased</i>	CU-0001	Yes	
6	EN-0008-LA1-00	UV 15 W 120V/60Hz Electronic Ballast <i>Recommend stocking 2 each for every 10 units purchased</i>	EN-0008-LA1-00	Yes	

7	12-8365	Firewall UV Relay PCB <i>Recommend stocking 2 each for every 10 units purchased</i>	EN-6127	Yes	
8	12-8300	UVC Sensor <i>Recommend stocking 2 each for every 10 units purchased</i>	AK-0063	Yes	
9	12-8305	Quartz Spiral for Firewall <i>Recommend stocking 1 each for every 10 units purchased</i>	FU-0007	Yes	
10	12-8370	Hot Water Faucet <i>Recommend stocking 2 each for every 10 units purchased</i>	PL-1351	Yes	
11	12-8355	Main PCB <i>Recommend stocking 2 each for every 10 units purchased</i>	EN-6126-L00-00	Yes	
12	12-8056	Silicon Button Key Mat <i>Recommend stocking 2 each for every 10 units purchased</i>	PL-1153	Yes	
13	12-8057	Button Label <i>Recommend stocking 2 each for every 10 units purchased</i>	LP-7084	Yes	
14	12-8150	Drip Tray Grill – Charcoal <i>Recommend stocking 2 each for every 10 units purchased</i>	PL-1152	Yes	
15	12-8055	Drip Tray - Charcoal with Waterlogic Logo <i>Recommend stocking 2 each for every 10 units purchased</i>	PL-1156	Yes	
Not Shown	01-2076	Scale Kleen <i>Recommend stocking 5 each</i>	NA	Yes	
Remaining Parts					
16	10-3067	Bulkhead Union ¼" x ¼" John Guest P/N PI1208S	PU-4028	Yes	
17	Purchase from John Guest	JG LLD PE Tube - Blue O.D.1/4" John Guest P/N PE-08-BI-1000F-B	PU-4031	No	
18	Purchase from John Guest	¼" Union Tee John Guest P/N P10208S	PU-4011	No	

19	Purchase from John Guest	1/4" Union Elbow John Guest P/N P10308S	PU-4008	No	
20	NA	2L (.5G) Cold Tank Assembly No UV holder, No sub-tank Counter Top Only	CT-2060-B	No	
21	Purchase from John Guest	JG Equal Straight Connector 1/4"(PI0408S)	PU-4010	No	
22	10-7040	Silicon Tube 5/16" for Hot Water	PU-4064-L00-00	Yes	
23	ST-0049-L00-00	Metal Cover – Counter Top Only	ST-0049-L00-00	Yes	
24	12-8375	Transformer 1.6A / 120 V for Firewall – Counter Top Only	EL-5147	Yes	
25	12-3165	Upper Shelf - Counter Top Only	ST-8150	Yes	
26	NA	Electric Ballast Bracket	ST-0059-L00-00	No	
27	12-8060	Flat Top Cover - Charcoal with Texture – Counter Top Only	PL-1249-CN	Yes	
28	12-8320	Firewall UV Lamp Rubber	CT-2088	Yes	
29	FW-0020-LA0-00	Firewall Buffer	FW-0020-L00	Yes	
30	TBD	Firewall Mark IV Stainless Assembly (No internal components)	FW-0027-I00-00	Yes	







31	12-8345	Silver Front Panel for Drip Tray Insert-Firewall	PL-1146-A	Yes	
32	12-8350	Firewall PCB Cover	PL-1357	Yes	
33	12-8360	Front Upper Insert Panel <i>Sold Separately:</i> 12-8056 Silicon Button Key Mat 12-8057 Button Label	PL-1359	Yes	
34	Purchase from John Guest	JG 3/8" x 1/4" Reducing Fitting(PI211208S)	PU-4137	No	
35	NA	Firewall Solenoid Valve Fixing Bracket - Counter Top Only	ST-8297	No	
36	NA	Filter Bracket - Counter Top Only	ST-8152-A	No	
37	12-3150	Unit Rubber Feet – Counter Top Only	PL-1251-CN	Yes	
38	12-3170	Bottom Tray - Counter Top Only	ST-8151-A	Yes	
39	12-3155	Leak Tray – Counter Top Only	PL-1294	Yes	
40	12-3180	Leak Containment Tray Clip (sensor 0.5mm)	ST-8207-CN	Yes	

Verify compressor in machine before ordering parts as the Compressor P/N CO-0020-L00-00 and 10-2200 (CO-0001A) and related parts are not interchangeable.

CO-0020-L00-00 Compressor

41A.1	CO-0020-L00-00	LG Compressor 120V R134A CSB035LJCM	CO-0020-L00-00	Yes	
41A.2	CO-0019-L00-00	Compressor Capacitor	CO-0019-L00-00	Yes	
41A.3	ST-0216-L00-00	Capacitor Bracket	ST-0216-L00-00	Yes	
41A.4	CO-0017-L00-00	PTC Relay	CO-0017-L00-00	Yes	
41A.5	CO-0018-L00-00	Overload Protector	CO-0018-L00-00	Yes	

CO-9001-A / 10-2200 Compressor

41B.1	10-2200	Compressor (R134a 1/8HP) 120V/60Hz	CO-9001-A	Yes	
41B.2	10-3003	Compressor Starter Relay	CO-9016	Yes	
41B.3	10-5018	Compressor Overload	CO-9015	Yes	
42	12-3100	Wire Condenser – Counter Top Only	CO-9031	Special Order	
42.1	12-1001	Filter Dryer	CO-9008	Yes	
43	12-8062	Side Panel - Counter Top Only	ST-8245	Yes	

44	Purchase from John Guest	JG 1/4" Stopper PI0808S (used with Bulkhead Union 1/4" x 1/4" John Guest P/N PI1208S) – Counter Top Only	PU-4086	No	
45	19-1069	Cold Tank Thermostat	CT-2070-A	Yes	
45.1	LP-0326	Cold Thermostat Cover Label	LP-0326-L00-00	Yes	
46	10-4013	Power Socket	EL-5016	Yes	
47	10-3014	Fuse Holder and Fuse 120V / 15A with One Wire	EL-5053	Yes	
47.1	10-3013	Fuse 120V / 15A	EL-5010	Yes	
48	10-3008	Red Compressor & Heater Switch	EL-5004	Yes	
49	12-8061	Silver Back Panel - Counter Top Only	ST-8216	No	
Not shown	10-3007	Power Cord 120V – 1840 mm	EL-5001-B	Yes	

WL350 TOWER LAYOUT DRAWING AND PARTS LIST

Yellow = Consumables

Green = Recommended spare parts

Wetted Parts

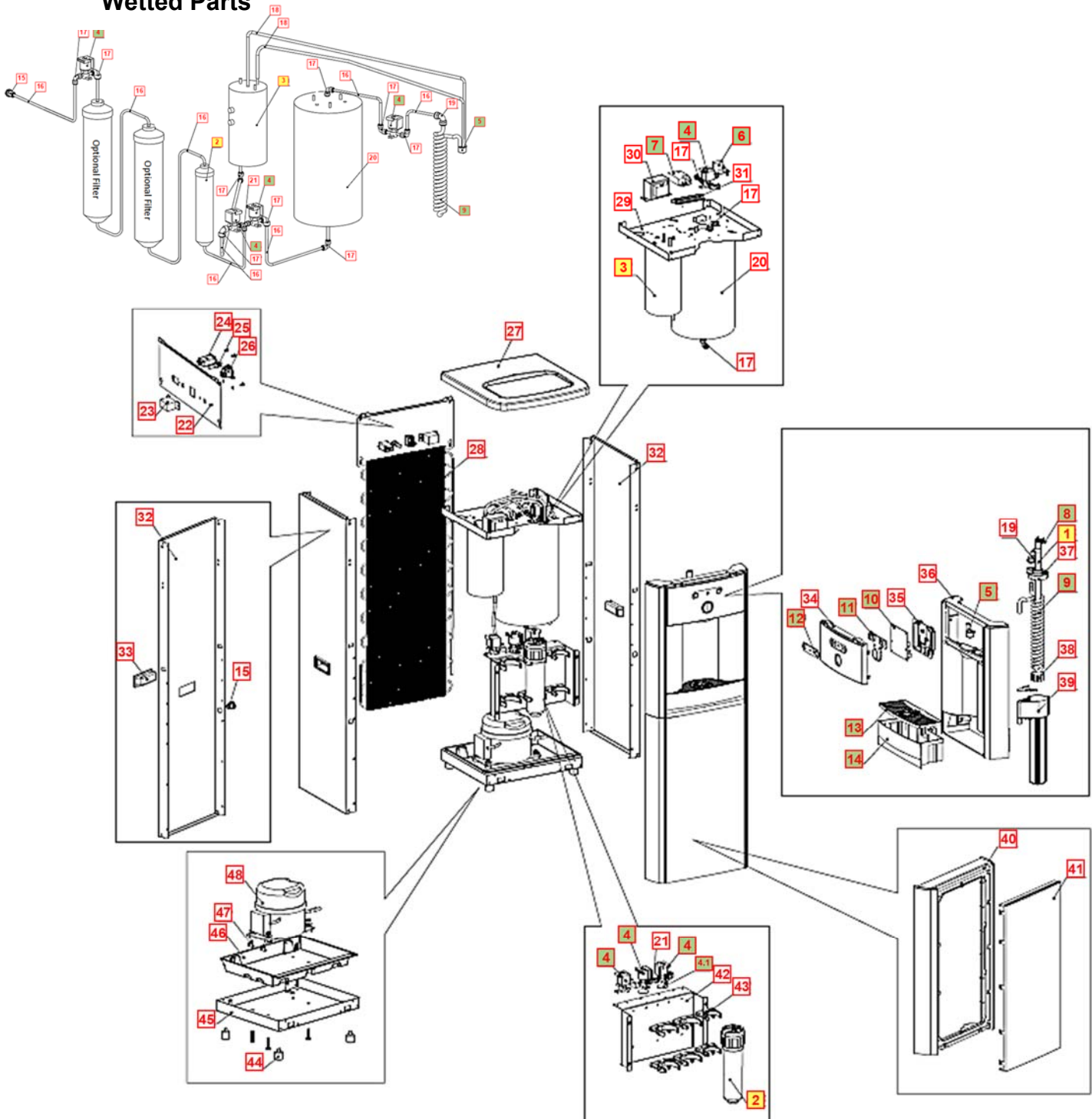

WL350 TOWER LAYOUT DRAWING AND PARTS LIST

No	WLCP Part No.	Description	Factory PN	Stocked?	
Consumables					
1	12-8310	15W LTFW XTM UV Lamp	CT-2085-IA0-00	Yes	
2	FT-0063-IL Assy with FT-0064 Element	1-micron 10" Inline CBC Filter for CTO, Lead, Cyst and Asbestos Reduction (Carbon Block) Required for NSF Certification	FT-0063-IL Assy with FT-0064 Element	Yes	
3	12-5615	Hot Tank 1.6 Liter (.42 gallon) 100V / 500W Factory Set Point 185°F - 85°C	HT-3041	Yes	
Recommended Spare Parts					
3.1	12-6900	Thermostat and Overload Metal Cover <i>Recommend stocking 2 each for every 10 units purchased</i>	ST-0045-L00-00	Yes	
3.2	12-1360	Overload with Manual Reset - 105°C (221° F) <i>Recommend stocking 2 each for every 10 units purchased</i>	HT-3012	Yes	
3.3	12-1303	Hot Tank Thermostat - 87°C (187°F) <i>Recommend stocking 2 each for every 10 units purchased</i>	HT-3013A	Yes	
4	TBD	Solenoid Valve 1000mm (recommend replacing Solenoid Cushion at same time) <i>Recommend stocking 2 each for every 10 units purchased</i>	PU-0017-100-00	Yes	
4.1	CU-0001	Solenoid Cushion <i>Recommend stocking 2 each for every 10 units purchased</i>	CU-0001	Yes	
5	12-8370	Hot Water Faucet <i>Recommend stocking 2 each for every 10 units purchased</i>	PL-1351	Yes	

6	12-8365	Firewall UV Relay PCB <i>Recommend stocking 2 each for every 10 units purchased</i>	EN-6127	Yes	
7	12-8315	UV 15 W 120V/60Hz Electronic Ballast <i>Recommend stocking 2 each for every 10 units purchased</i>	EN-0008-L01-00	Yes	
8	12-8300	UVC Sensor Wire - 2FW *Includes: UVC Sensor wire with CT-2089 and PL-1358 <i>Recommend stocking 2 each for every 10 units purchased</i>	AK-0063	Yes	
9	12-8305	Quartz Spiral	FU-0007	Yes	
10	12-8355	Main PCB <i>Recommend stocking 2 each for every 10 units purchased</i>	EN-6126-L00-00	Yes	
11	12-8056	Silicon Button Key Mat <i>Recommend stocking 2 each for every 10 units purchased</i>	PL-1153	Yes	
12	12-8057	Button Label <i>Recommend stocking 2 each for every 10 units purchased</i>	LP-7084	Yes	
13	12-8150	Drip Tray Grill – Charcoal <i>Recommend stocking 2 each for every 10 units purchased</i>	PL-1152	Yes	
14	12-8055	Drip Tray - Charcoal with Waterlogic Logo <i>Recommend stocking 2 each for every 10 units purchased</i>	PL-1156	Yes	
Not Shown	01-2076	Scale Kleen <i>Recommend stocking 5 each for every 10 units purchased</i>	NA	Yes	
Remaining Parts					
15	10-3067	Bulkhead Union ¼" x ¼" John Guest P/N PI1208S	PU-4028	Yes	
16	Purchase from John Guest	JG LLD PE Tube - Blue O.D.1/4" John Guest P/N PE-08-BI-1000F-B	PU-4031	No	



17	Purchase from John Guest	1/4" Union Elbow John Guest P/N P10308S	PU-4008	No	
18	10-7040	Silicon Tube 5/16" for Hot Water	PU-4064-L00-00	Yes	
19	Purchase from John Guest	JG 3/8" x 1/4" Reducing Fitting(P1211208S)	PU-4137	No	
20	NA	4L (1G) Cold Tank Assembly (No UV holder, No sub-tank) – Tower Only	CT-2017-A	No	
21	Purchase from John Guest	1/4" Union Tee John Guest P/N P10208S	PU-4011	No	
22	12-5673	Silver Back Panel	ST-8135-A	No	
23	19-1069	Cold Tank Thermostat	CT-2070-A	Yes	
23.1	LP-0326	Cold Thermostat Cover Label	LP-0326-I00-00	Yes	
24	10-4013	Power Socket	EL-5016	Yes	
25	EL-5053	Fuse Holder and Fuse 120V / 15A with One Wire	EL-5053	Yes	
25.1	10-3013	Fuse 120V / 15A	EL-5010	Yes	
26	10-3008	Red Compressor & Heater Switch	EL-5004	Yes	

27	12-8054	Top Cover – Tower Only	PL-1250	Yes	
28	12-8102	Wire Condenser – Tower Only	CO-9027	Special Order	
28.1	12-1001	Filter Dryer	CO-0008	Yes	
29	12-8003	Upper Shelf	ST-8136-R2	Yes	
30	12-3117	Transformer 1.6A / 120 V for Firewall – Tower Only	EL-5003-A	Yes	
31	ST-0059-L00-00	Electric Ballast Bracket	NA	No	
32	12-8000	Silver Side Panel with Hole for Handle – Tower Only	ST-8157	Yes	
33	12-8058	Side Panel Plastic Handle Tower Only	PL-1123	Yes	
34	12-8360	Firewall Front upper insert panel	PL-1359	Yes	
35	12-8350	Main PCB Cover	PL-1357	Yes	
36	12-8345	Silver Front Panel for Drip Tray Insert-Firewall	PL-1146-A	Yes	
37	12-8320	Firewall UV Lamp Rubber	CT-2088	Yes	





38	FW-0020-LA0-00	Firewall Buffer	FW-0020-L00	Yes	
39	TBD	Firewall Mark IV Stainless Assembly (No internal components)	FW-0027-I00-00	Yes	
40	12-8052	Front Bottom Panel – Tower Only	PL-1148	Yes	
41	12-8053	Front Bottom Insert Panel – Tower Only	PL-1149	Yes	
42	12-8005	Filter Bracket – Tower Only	ST-8138	Yes	
43	20-1010	2.8" Filter Clip	PU-4161	Yes	
44	10-3083	Unit Rubber Feet – Tower Only	ST-8167CN	Yes	
45	12-8004	Bottom Tray	ST-8137	Yes	
46	NA	Leak Tray – Tower Only	PL-1294-A	No	
47	12-3180	Leak Containment Tray Clip (sensor 0.5mm)	ST-8207-CN	Yes	

Verify compressor in machine before ordering parts as the Compressor P/N CO-0020-L00-00 and 10-2200 (CO-0001A) and related parts are not interchangeable.

CO-0020-L00-00 Compressor

48A.1	CO-0020-L00-00	LG Compressor 120V R134A CSB035LJCM	CO-0020-L00-00	Yes	
48A.2	CO-0019-L00-00	Compressor Capacitor	CO-0019-L00-00	Yes	
48A.3	ST-0216-L00-00	Capacitor Bracket	ST-0216-L00-00	Yes	
48A.4	CO-0017-L00-00	PTC Relay	CO-0017-L00-00	Yes	
48A.5	CO-0018-L00-00	Overload Protector	CO-0018-L00-00	Yes	

CO-9001-A / 10-2200 Compressor

48B.1	10-2200	Compressor (R134a 1/8HP) 120V/60Hz	CO-9001-A	Yes	
48B.2	10-3003	Compressor Starter Relay	CO-9016	Yes	
48B.3	10-5018	Compressor Overload	CO-9015	Yes	
Not shown	10-3007	Power Cord 120V – 1840 mm	EL-5001-B	Yes	

WL350 COUNTER TOP WATER FLOW DIAGRAM

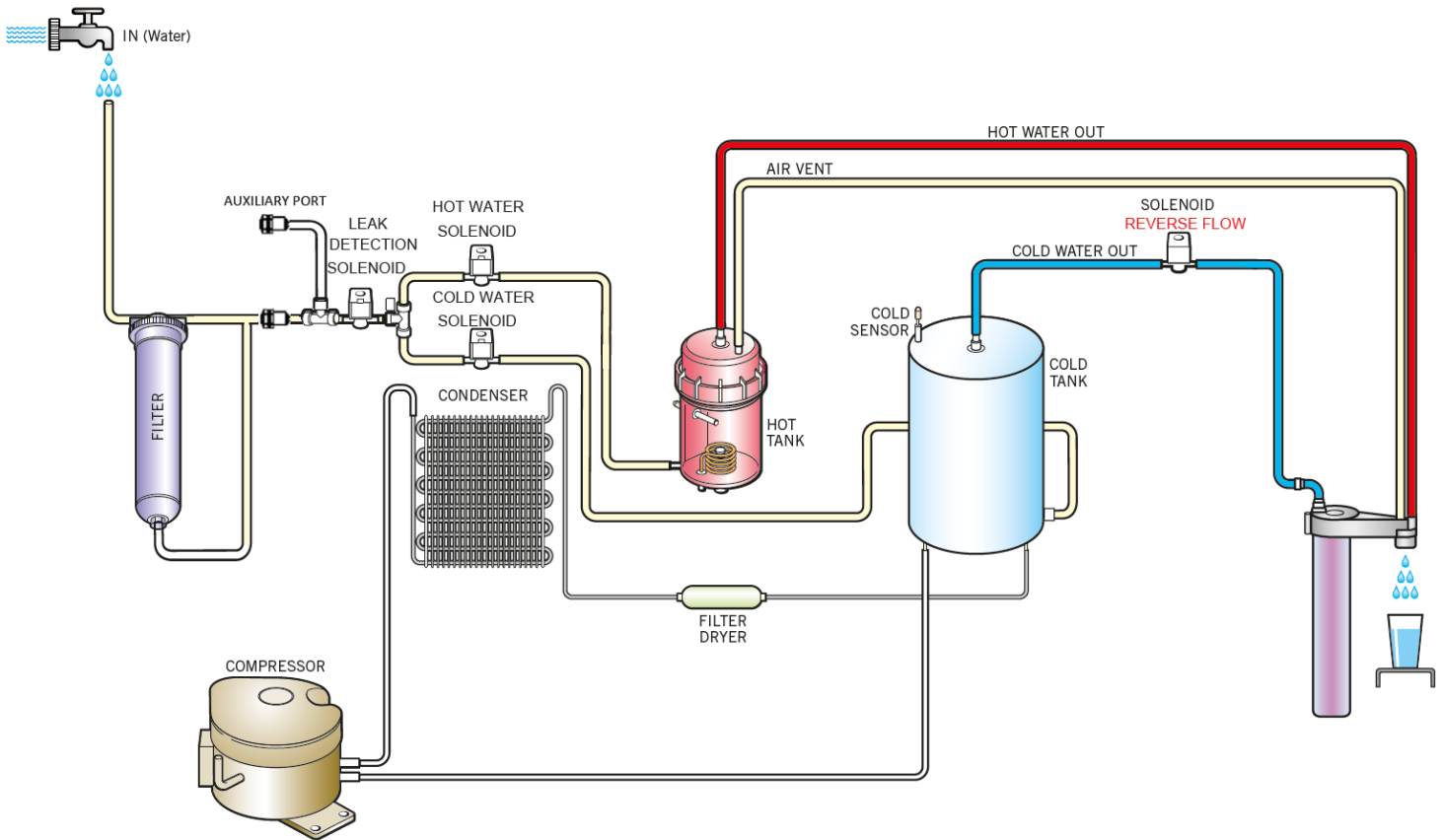

WL350 TOWER WATER FLOW DIAGRAM

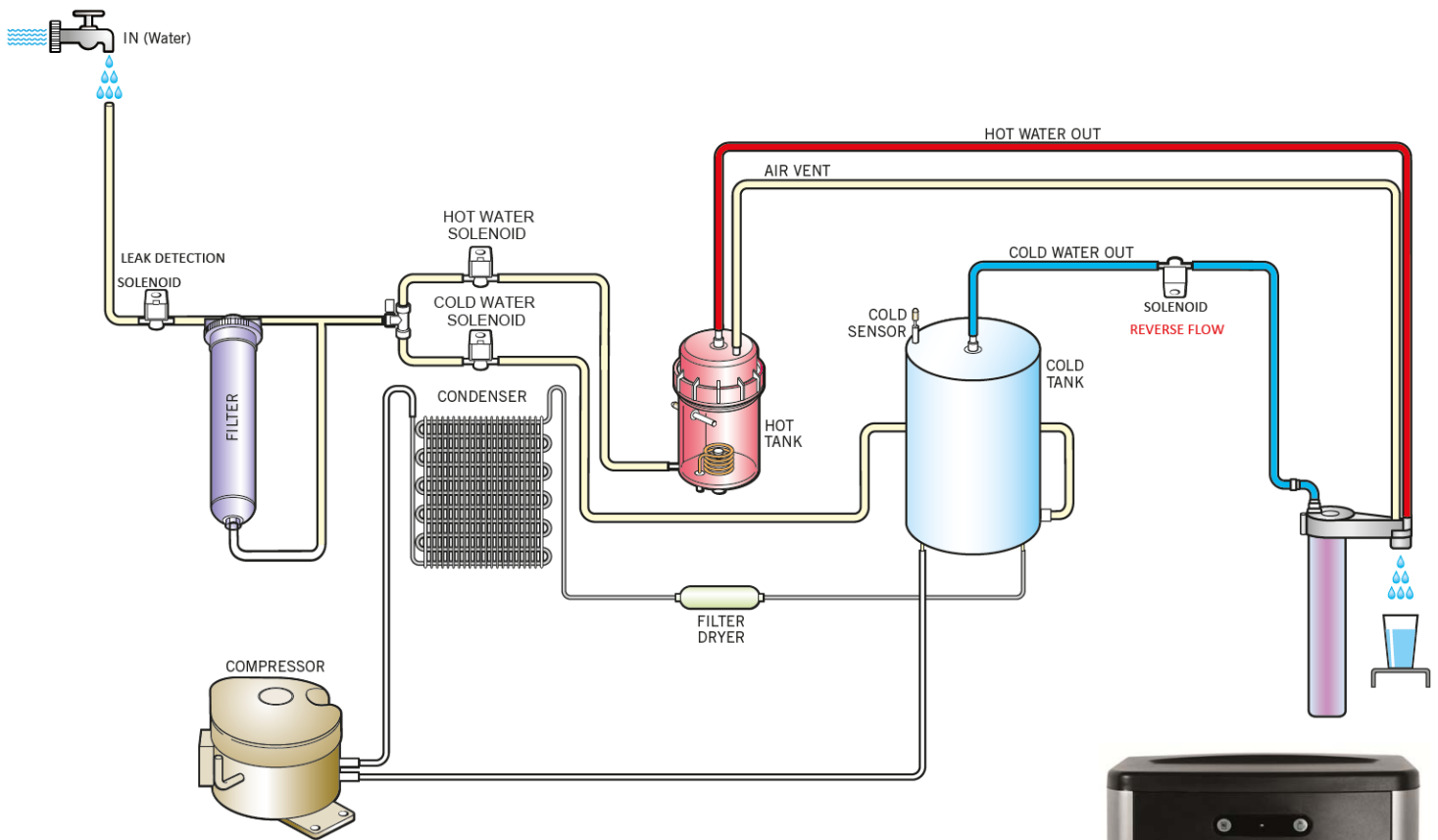

WL350 ELECTRICAL DIAGRAM

⚠ DANGER! HIGH VOLTAGE ELECTRICAL HAZARD. PCB (Printed Circuit Board) contains High Voltage. Only trained and qualified technicians should attempt live testing.

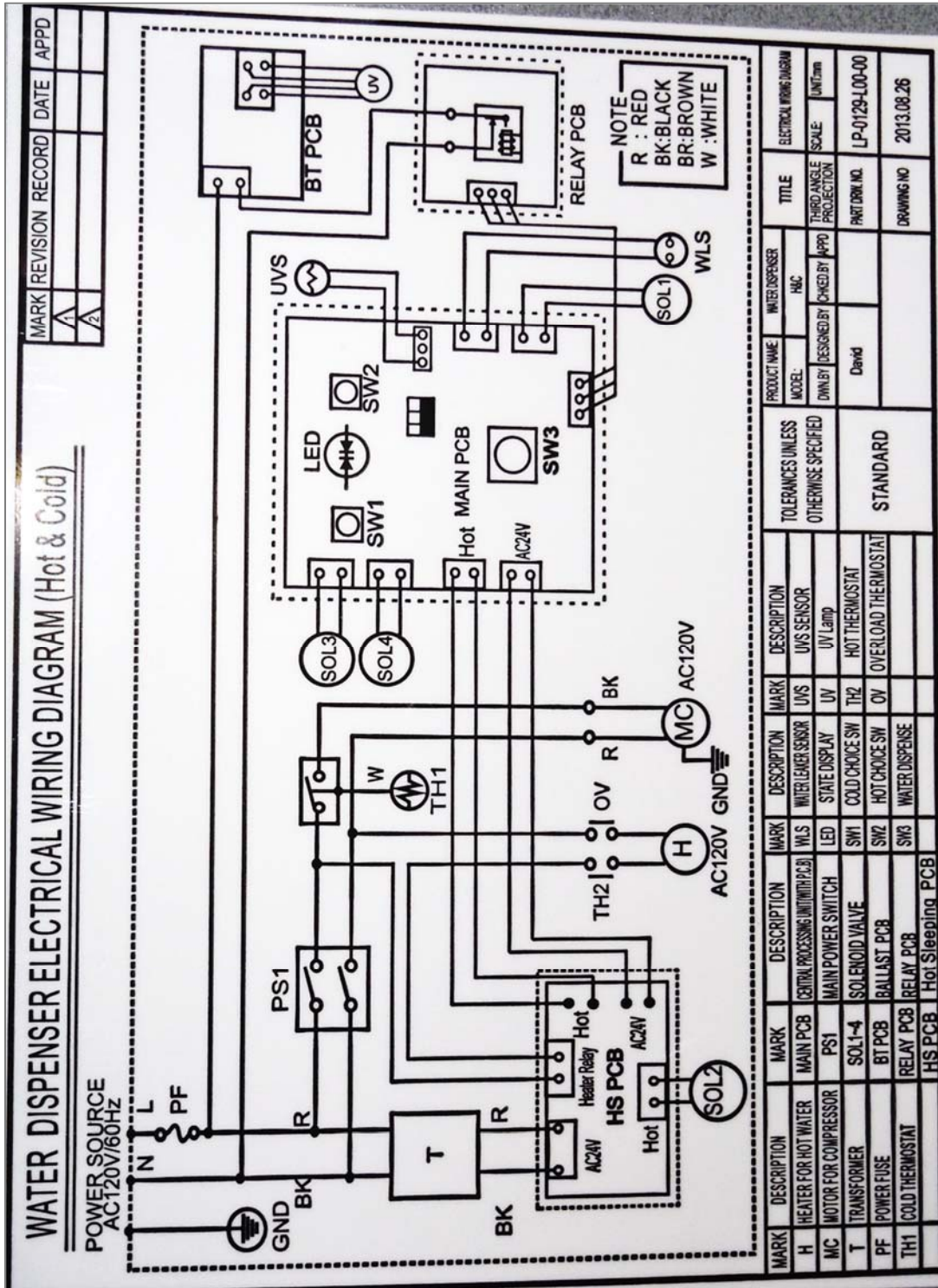

MARK	REVISION	RECORD	DATE	APPD
1				
2				

PRODUCT NAME		WATER DISPENSER		ELECTRICAL WIRING DIAGRAM	
MODEL	HMC	THIRD ANGLE PROJECTION	SCALE	UNIT/mm	
DESIGNED BY	David	CHECKED BY	APPD	PART DRAWING NO.	LP-0129-L00-00
TOLERANCES UNLESS OTHERWISE SPECIFIED			STANDARD		
DRAWING NO		2013.08.26			