

## PRE-INSTALLATION PROCEDURES

**⚠️ DANGER! ELECTRICAL SHOCK HAZARD.**

*Only qualified personnel who have read and understand this entire manual should attempt to install, or service this unit, failure to do so could result in death or serious injury.*

**⚠️ WARNING! ALWAYS SANITIZE BEFORE USE.**

*Sanitize before use to eliminate any potential microbiological contaminants.*

*Red Compressor/Heater Switch must be in the O=OFF position while the Hot Tank is empty. Damage could occur within one minute and the two Hot Tank Overload Devices (High Safety Limit) require manual reset if heater is turned on with an empty Hot Tank.*



**⚠️ CAUTION! DRIP TRAY DRAIN.**

*If you intend to provide a drip tray drain for your customer, be aware that you will be called multiple times per month to service and unclog the tubing leading away from the drip tray to drain. Users will clog the drain with paper clips, erasers, napkins, tea bags, gum, and various other intended items. Waterlogic recommends you establish a minimum of weekly visits to the machine for cleaning of the drip tray drain.*

### Washing of the Internal Plastic Reservoir, Lid and Float

#### Materials Needed:

- Personal Protective Equipment. Rubber or Nitrile Safety Gloves and Protective Eyewear
- Phillips Screwdriver
- Sanitizer - Household Bleach (5.25% Sodium Hypochlorite) or Citric Acid Based Cleaner
- Unused sponges or paper towels
- Dish Soap
- Clean water

1. Unpack the **Waterlogic WL270 Water Treatment System** and check exterior for damage.

**⚠️ CAUTION! ALWAYS WASH THE INTERNAL PLASTIC RESERVOIR, LID AND FLOATS PRIOR TO INSTALLATION.**

*The internal wetted surfaces of the machine have been handled multiple times in the process of manufacturing. By following the steps below, you will ensure the cleanliness and sterility of the drinking water. Refer to the flow diagram in this manual prior to washing of the plastic reservoir, lid and floats.*

2. Remove the Top Cover and Lower Panel of the **WL270 Water Treatment System**. The two screws securing the top cover are located in each rear corner. The two screws securing the lower front panel are located on the front, lower sides near the floor.



3. Completely remove the Plastic Internal Reservoir from the **WL270 Water Treatment System**.

- 3a. Remove and discard the clear silicon float protector from the electronic float.
- 3b. Loosen the water supply line fitting from the Mechanical Float.
- 3c. Unplug the white disconnect attached externally to the electronic float.
- 3d. Pull the silicon ¼" vent line loose from the Hot Tank where it attaches to the Plastic Reservoir.

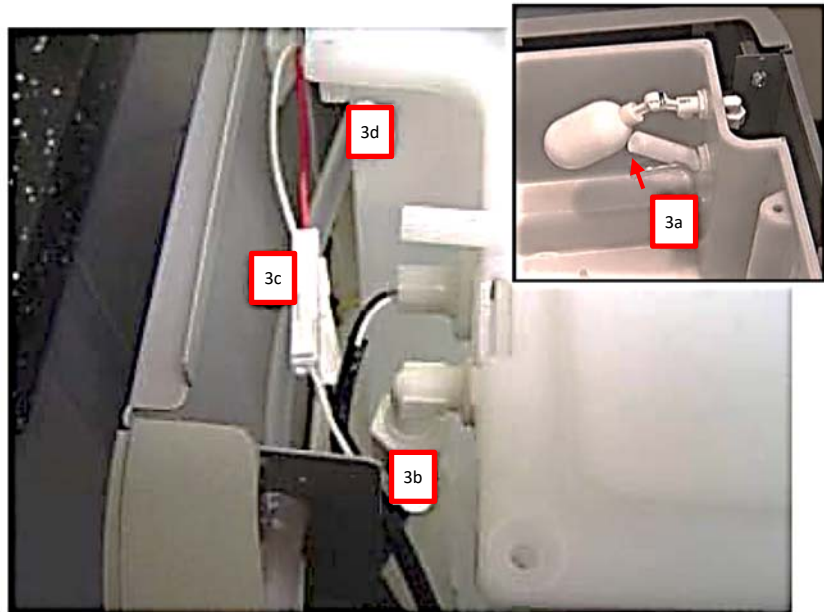

4. Scrub the internal surfaces with soapy water using an unused sponge or paper towels.
5. Rinse well with clean water.
6. While avoiding touching the wetted surfaces of the reservoir with your hands, reinstall the Reservoir into the **WL270 Water Treatment System**, reversing the removal steps you performed prior.

### Sanitizing the machine

#### Materials Needed:

- Personal Protective Equipment. Rubber or Nitrile Safety Gloves and Protective Eyewear
  - Phillips Screwdriver
  - Sanitizer - Household Bleach (5.25% Sodium Hypochlorite) or Citric Acid Based Cleaner
  - Unused sponges or paper towels
7. Install the Hose Adaptor fitting that is packed in the accessories bag found in the drip tray onto the water inlet fitting on the back of the machine.

**⚠ CAUTION! DO NOT OVERTIGHTEN**

8. Install the metal stand-off plate from the accessories bag and install over the water inlet. Connect a section of the ¼" plastic tubing from the water supply line into the hose adaptor fitting at the back of the unit.

**⚠ CAUTION! DO NOT TURN ON THE WATER YET**

**⚠ CAUTION! FILTER FLUSHES REQUIRED.**

*WL270 Water Treatment Systems are not supplied with filters. Filters should be configured to optimize your system. Filters need to be configured and specified to do the job given the local water conditions, usage, maintenance schedule, and placement restrictions.*

*In order for our filters to perform as represented and to provide the best quality water possible, it is essential that filters be replaced periodically. The frequency of filter changes depends upon your water quality and your water usage. For example, if there is a lot of sediment and/or particles in your water, then you will have to change your filters more frequently than a location with little to no sediment. Be sure to replace your filters whenever you notice a decline in the performance, whether it is a drop in flow rate and/or pressure or an unusual taste in the water.*

9. Flush thoroughly per filter manufacturers' recommendation with fresh water to drain.
10. Once flushed, install the filters. Following the flow direction on the filters.

**NOTE:** Filters should not be flushed prior to 24 hours before installation to limit Microbial Growth.

*If you intend to use the Waterlogic RO System, you must remove the filter plate supplied behind the lower front panel (four screws total). The RO System then mounts on the rails just above the compressor. Route the RO drain line through the port that is protected by the rubber grommet on the back of the machine.*

11. Remove the lid to the internal reservoir of the **WL270 Water Treatment System**.
12. Pour 2 tablespoons of Sanitizer - Household Bleach (5.25% Sodium Hypochlorite) or Citric Acid Based Cleaner in the reservoir.
13. Replace the reservoir lid.
14. Unplug one of the white disconnects supplying power to the UV lamp. *This step will prevent interaction between the sanitizer and the UV.*

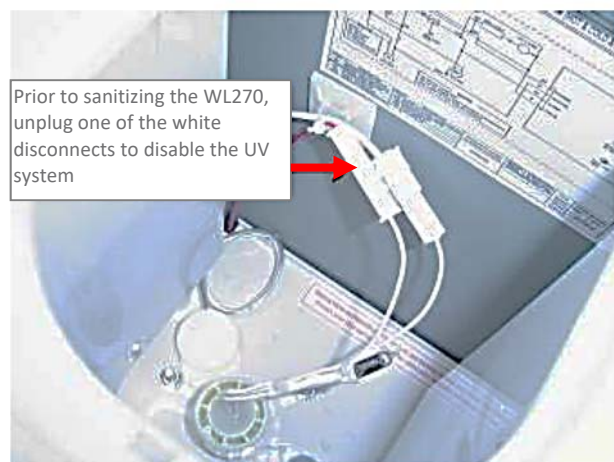

*Red Compressor/Heater Switch must be in the O=OFF position while the Hot Tank is empty. Damage could occur within one minute and the overload (high limit) will require manual reset if heater is turned on with an empty Hot Tank.*



15. Turn on the water and plug the **WL270 Water Treatment System** to a power source. Verify the power LED is illuminated on the front of the unit. The unit should start to fill.
16. Once the reservoir has filled halfway with water, drop two more tablespoons of Sanitizer - Household Bleach (5.25% Sodium Hypochlorite) or Citric Acid Based Cleaner in the reservoir.
17. Once the reservoir has filled, depress and hold the cold dispense button. This action fills the cold tank. There will be a pause of up to one minute before the water starts to dispense from the **WL270 Water Treatment System** Faucet.

**⚠ WARNING!** Use Personal Protective Equipment. Gloves and Eye Protection Required. The first 2 or 3 gallons of water will contain concentrated sanitizer. Use extreme care!

18. Once the cold tank is filled (when the water starts streaming into the glass under the faucet, release the cold dispense button. Depress and verify chlorinated dispenses from the Ambient faucet.
19. Depress and verify chlorinated water flows from the hot faucet.
20. After water flows from all 3 faucets, turn on the Red Compressor / Heater Switch.

*Red Compressor/Heater Switch must be in the I=ON position.*



The compressor and Hot Tank heater systems will begin to operate. The heater LED (not the word heater, but the LED above the word “heater”), and the blue chilling LED on the front indication panel of the machine will be illuminated.

21. Allow the sanitizing solution to remain in the machine until the red heater LED turns off – about 10 minutes.
22. Place a pitcher under the Cold Faucet of the **WL270 Water Treatment System** and dispense 1 gallon of water. Do the same with the Ambient and Hot Faucets.
23. Turn off the Red Compressor / Heater Switch. Unplug the unit. Switch off the cold and hot drain caps on the back of the unit. Drain the **WL270 Water Treatment System**, replace drain caps.  
*Red Compressor/Heater Switch must be in the O=OFF position.*



24. Reconnect the UV wiring connectors.
25. With the Red Compressor / Heater Switch off, plug the **WL270 Water Treatment System** back into the power source. Ensure the power LED is illuminated on the front of the **WL270 Water Treatment System**. The unit should start to fill.

**⚠ DANGER! ELECTRICAL SHOCK HAZARD.**

*Do not plug in unit unless qualified. Only qualified personnel who have read and understand this entire manual should attempt to install or service this unit.*

26. Verify the UV Lamp has a faint blue glow underneath the silicon fittings on top of the UV lamp to ensure it is working. The UV Lamp is directly connected to the electronic float, meaning the lamp will only be turned on when the unit is filling.

**⚠ CAUTION! NEVER LOOK DIRECTLY AT A WORKING UV LAMP, EYE DAMAGE WILL OCCUR.**

*UV Lamp Sensor is temperature sensitive. During extended periods of use, especially when filling or draining the unit when water is not being dispensed, UV Lamp Sensor can overheat, initiating a UV Fault. If this occurs, turn off unit for 5 minutes and allow sensor to cool before resuming operation.*

27. Replace the top cover.
28. Once the reservoir has re-filled, verify that all of the sanitizer has been rinsed from the hot, cold and ambient faucets. Continue dispensing water from the faucets until the water tests chlorine free. Draining, refilling and dispensing more water from the unit may be necessary to ensure the water is chlorine free.
29. Turn on the Red Compressor / Heater Switch. This will start the chilling and heating processes.

*Red Compressor/Heater Switch must be in the I=ON position.*



30. Verify the compressor starts by feeling the head of the compressor for vibration. The temperature in the cold tank should reach its target temperature within 45 minutes. When the unit has reached target cold temperature, the compressor will cycle off. The Hot Tank will take considerably less time to reach its target temperature of 83° (181°F).
31. After the cold and hot water temperatures have been reached, turn the Red Heater/Compressor Switch off.

*Red Heater and Compressor Power Switch must be in the O=OFF position while the Hot Tank is empty. Damage could occur within one minute and the overload (high limit) will require manual reset if heater is turned on with an empty Hot Tank.*



## **DRAINING INSTRUCTIONS**

Drain the **WL270** Water *Treatment System* for transportation.

**⚠ WARNING! STORE UNIT EMPTY. ALWAYS SANITIZE BEFORE REUSE.**

*The unit must be completely drained and sealed before storing to avoid stagnation and reduce microbial growth).*

Prior to draining the Hot Tank, turn off the Red Heater and Compressor Power Switch *O = OFF*, and dispense 2 liters of hot water from the machine. As hot water is dispensed from the faucet of the unit, colder water will be introduced into the Hot Tank. Since the Red Power switch is turned off, the heater will not energize and heat the incoming tap water. Following this precaution prevents exposing personnel and equipment (drains, catch basin, etc.) to scalding hot water.



### **Disable Cold and Hot Tanks**

1. Turn off the Red Heater and Compressor Power Switch to disable the heater and compressor.
2. Dispense 2 liters of water through the Hot Tank to cool the water temperature in the Hot Tank and avoid burns.



**⚠ WARNING! HOT WATER CAN BURN OR SCALD.**

*Hot water should be dispensed carefully into insulated container to avoid injury.*

### **Turn off Water Supply and Bleed Water Pressure**

3. Isolate the unit from feed water by turning off the supply.
4. Dispense cold still water to relieve any pressure built up in the system.
5. Remove the water supply line from the hose adaptor.

### **Drain the Cold Water Tank and Circuit**

6. Remove Hose Adaptor.
7. Remove Drain Caps located on back of unit.
8. After unit drains, replace drain caps.

## INSTALLATION PROCEDURES

### Safety and Installation Guidelines

Ensure all Local, State, and Federal Laws and Codes including health and safety guidelines are met when installing **Waterlogic** Equipment. Only qualified service technicians should attempt installation and service of **Waterlogic** Equipment.

**⚠ WARNING! ELECTRICAL SHOCK HAZARD.** Always unplug (isolate from power supply) to prevent electrical shock except where electrical tests are specified.

**⚠ WARNING! IMPROPER SUPPLY OR CONNECTION CAN RESULT IN RISK OF SHOCK.** Connect to a 15 amp 120V 60Hz properly grounded outlet (GFI is recommended). Ensure polarity is correct and always use a 3-prong outlet. Consult a qualified electrician if you have any questions.

**⚠ WARNING! USE ONLY Waterlogic SUPPLIED POWER CORD.** Locate system within 5 feet of power supply. Never use an extension cord or adapter. Do not use a damaged power cord or plug. Keep power cord out of heavy traffic areas and away from heat sources. Do not, under any circumstances, remove ground prong or alter the power cord. Never pull the power plug from the outlet with a wet hand or allow the plug to get wet. Failure to use the supplied power cord will void UL Certification and Warranty.

**⚠ CAUTION! INDOOR USE ONLY.** Never expose to direct sunlight, heat sources, or ambient air temperature above 100°F (37°C) or below 35°F (2°C). Install indoors and keep unit away from excessive humidity. Never expose to freezing temperatures. Ensure there is adequate clearance around the unit to allow refrigeration system condenser to dissipate heat. Warmer environments require more clearance around the unit. Minimum clearance around all surfaces of the machine is 2-inches. Installs where the ambient temperature exceeds 80 °F, require a minimum of 4-inches clearance for proper heat dissipation and efficient operation.

**⚠ CAUTION! USE A WATER PRESSURE REGULATOR.** Waterlogic will not be responsible for injury or damage caused by excessive water pressure. Operating pressure must be 40 psi to 60 psi. Be aware any of potential pressure surges caused by building/municipal pumping stations.

**⚠ CAUTION! USE UV STABILIZED SUPPLY LINES.** Feed the unit with a potable ambient or cold water supply only. Feed water over 100°F (37°C) can damage the treatment components. Water block devices and external leak detectors are strongly recommended. Locate the unit as close to the water supply and the electrical connections as possible.

**⚠ WARNING! STORE AND TRANSPORT UNIT EMPTY. ALWAYS SANITIZE BEFORE USE.** The unit must be completely drained and sealed before storing to avoid stagnation and reduce microbiological contamination (potential bacterial growth). Sanitize before use to eliminate any potential microbiological contaminants

Pre-installation and sanitization procedures as prescribed in this manual must be performed before installing the **WL270 Water Treatment System**.

Always install indoors and place the **Waterlogic WL270 Water Treatment System** on a firm, flat and stable surface.

1. Attach the water supply line to the 1/4" feed water hose adaptor fitting on the back of the unit. **Waterlogic** requires the use of a water pressure regulator. Water feed pressure must be between 40-60 psi. Turn on the water supply and check for leaks.
2. Check to ensure that the Red Heater and Compressor Power Switch is the *O=OFF* position.

**NOTE:** Switches have internal LED that illuminates when placed in I=ON position.



3. Connect the power cord to the back of the **Waterlogic WL270 Water Treatment System** and to a 120 Volt supply.
4. Turn on water supply and allow reservoir to fill.
5. Fill the Cold Tank. Hold a container under the dispensing faucet, press and hold the cold dispensing button until a continuous flow of water is obtained. Once a continuous flow is obtained, release the dispensing button. Cold tank is now full.
6. Fill the Hot Tank. Hold a container under the dispensing faucet. Press and hold down the Red Hot Safety Button (LEFT hand side) dispensing button followed by the Pressing and Holding down the Hot Dispensing Button at the same time until a continuous flow of water is obtained. Once a continuous flow is obtained, release the main dispensing button. Hot Tank is now full.

**⚠ CAUTION! NEVER TURN ON HEATER BEFORE FILLING HOT TANK.**

*Red Heater and Compressor Power Switch must be in the *O=OFF* position while the Hot Tank is empty. Damage could occur within one minute and the overload (high limit) will require manual reset if heater is turned on with an empty Hot Tank.*





7. Verify that the UV lamp operates as expected.

**⚠ WARNING! ULTRAVIOLET RADIATION.** *Protect your skin and eyes against ultraviolet rays. Never look directly at an operating UV light. Always disconnect before removal.*

8. Move the **Waterlogic WL270 Water Treatment System** into its final operating position. Be sure that a minimum of 2" clearance is maintained around both the sides and the back of the unit. This is important to allow proper airflow and heat exchange of refrigeration system.

9. Level unit using the adjustable feet to level if necessary. Never install on incline.

10. Turn the Red Heater and Compressor Power Switch to *I=ON* position.



11. When the unit has reached its Hot Temp Set Point, the heater will cycle off. When the unit has reached its Cold Temp Set Point Temperature, the compressor will cycle off.

12. Once the unit is at the target temperature(s), sample the water to ensure water meets expectations and additional rinsing or adjustment is not required.

13. Check the unit for any leaks. External Leak Protection is always recommended.