

WL15-CHA WATER FLOW DIAGRAM

Yellow = Consumables

Green = Recommended spare parts

WL has elected to only stock select parts of the WL15. These parts are boxed in Red.

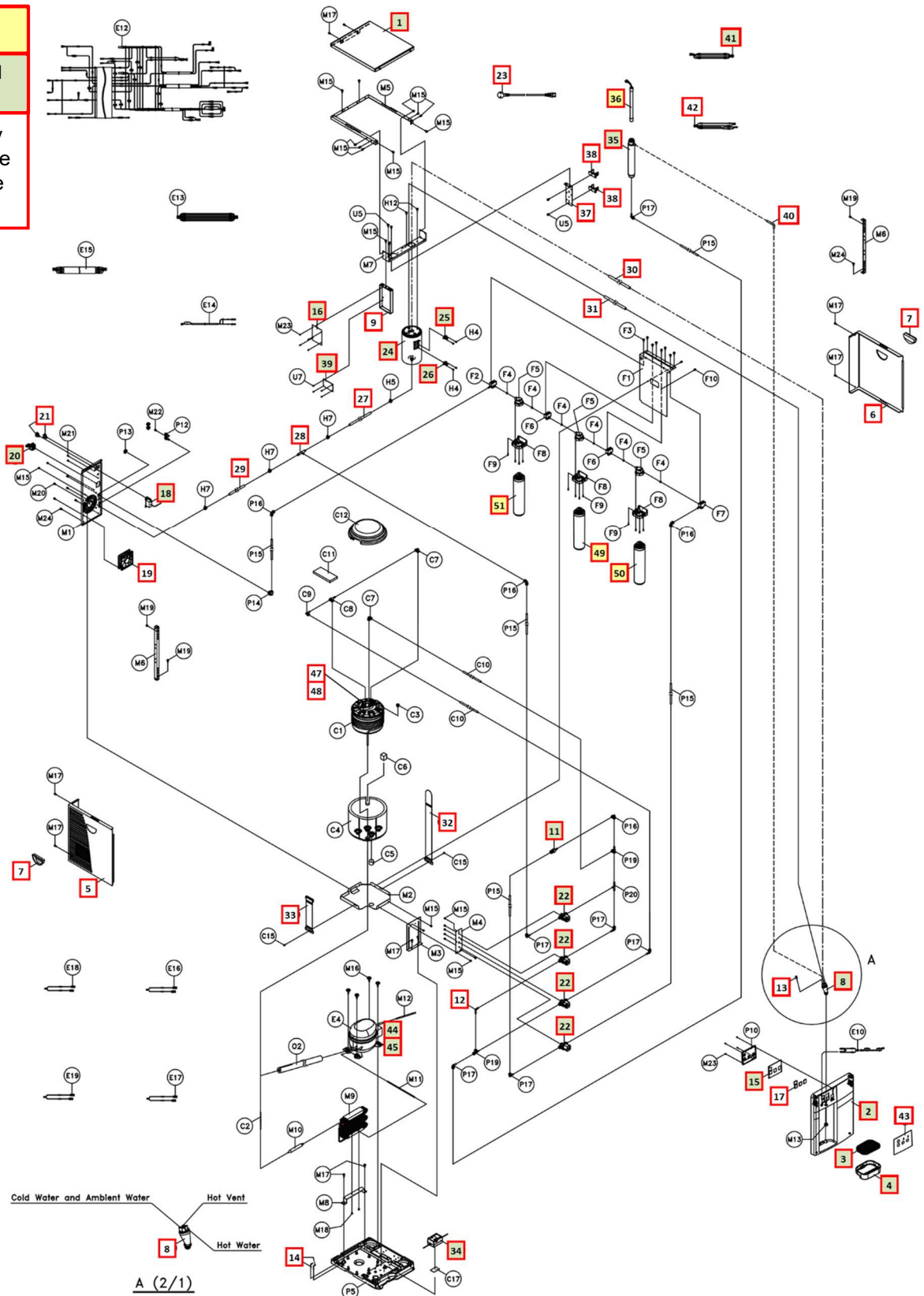



No	WL Part No.	Description	Charm Part No.	
1	15-9005	TOP COVER, BLACK	3PC818-02-BK	
2	15-9010	FRONT PANEL, SILVER	3PC8181A-01-7L	
3	15-9015	DRIP TRAY GRILL, SILVER	3PC818-08-1	
4	15-9020	DRIP TRAY GRILL	3PC818-07-BK	
5	15-9025	LEFT SIDE PANEL, BLACK	3PC-PR-03S-BK	
6	15-9030	RIGHT SIDE PANEL, BLACK	3PC-PR-04-BK	
7	15-9035	HANDLE	3PT789-09-BK	
8	15-9040	4-WAY FAUCET	2PC698H-06-4-01	
9	15-9175	MAIN PCB MOUNTING BOX	3PCM104-09	
10	15-9176	DUAL DRAIN PORT W/ O-RINGS	2PC698H-13-1	

11	15-9177	INLINE FILTER, QUICK CONNECT	2PC-Z23*	
12	15-9178	ELBOW VENT FITTING	3PC-Z20-L-2	
13	15-9045	SILICON CAP FOR UNUSED PORT	3SO-013-2	
14	15-9050	M14 LEAK DETECTION PROBES	3M-Z2318-6	
15	15-9055	TOUCH PCB	3E-IC818A-TC-DC	
16	15-9060	MAIN PCB	3E-IC103-CHST-B	
17	15-9065	LIGHT GUIDE PLATE	3E-LT-01	
18	15-9179	COLD TANK THERMOSTAT	3E-C025	
19	15-9070	FAN UNIT	3E-Z112	
20	15-9180	3 PIN SOCKET W/ FUSE AND FUSE BLOCK	2WL-Z003-10A	

21	15-9181	BOAT TYPE SWITCH	3E-Z225	
22	15-9075	LARGE FLOW VOLUME SOLENOID VALVE	2R-E301A-EZ	
23	10-3007	STANDARD POWER CORD, 120V, 1840mm	3WL015+005	
24	15-9080	HOT WATER TANK COMPLETE SET	3M-TW-L728-BD	
25	15-9085	92C OVERLOAD	3E-C015-1	
26	15-9090	82C THERMOSTAT	3E-C016-4	
27	15-9095	SILICONE PIPE, HOT DRAIN	3SI-085-095	
28	15-9100	TEE FITTING	3PC-698H-14-1	
29	15-9105	SILICONE PIPE, HOT DRAIN	3SI-085-245	

30	15-9110	SILICONE PIPE, HOT TO FAUCET	3SI-088-210	
31	15-9115	SILICONE PIPE, HOT VENT TO FAUCET	3SI-088-190	
32	15-9184	ICE VELCRO FELT (LONG)	3Z-C027	
33	15-9185	ICE VELCRO FELT (SHORT)	3Z-C028	
34	15-9188	TRANSFORMER (CHA)	3E-T09-6	
35	15-9130	UV HOUSING	2R-UVL-32	
36	15-9135	UV LAMP	2R-UVL-31	
37	15-9140	FIXTURE OF SOLENOID VALVE	3M-215-07	
38	15-9145	UV CLIP	3R-P105-1	
39	15-9150	PCB OF UV STABILIZER	3E-ICUV-D	

40	15-9155	L TYPE SILICON TUBE, TO FAUCET	3SL-028	
41	15-9160	CONNECTING WIRE OF UV LAMP	3WL-298-17	
42	15-9165	UV CONTROLING WIRE	3WL-298-16	
43	15-9189	TOUCH PANEL INDICATION STICKER (CHA)	3F1-818ACWH-01	
44	15-9186	STARTER RELAY, COMPRESSOR	N/A	
45	15-9187	OVERLOAD RELAY, COMPRESSOR	N/A	
46	15-9000	HCA TOUCHLESS MODULE (OPTIONAL)	N/A	
47	15-9190	WATER LEVEL SENSOR PROBE (60MM)	3M-Z2318-4	

48	15-9191	WATER LEVEL SENSOR PROBE (50MM)	3M-Z2318-9	
49	FT-0035 (OPTIONAL)	GAC FILTER – 10” CARBON ACTIVATED INLINE FILTER OPTIONAL FILTER ELEMENT FT-0038-WLT	N/A	
50	FT-0063 (OPTIONAL)	CARBON BLOCK – 10” CBC 1-MICRON LEAD AND CYST REDUCTION INLINE FILTER OPTIONAL FILTER ELEMENT FT-0064-WLT	N/A	
51	FT-0053 (OPTIONAL)	SEDIMENT FILTER – 10” SEDIMENT 20 MICRON INLINE FILTER OPTIONAL FILTER ELEMENT FT-0055-WLT	N/A	